

Bike	Tracer 700	Part No.	RYA-108-SYS
Year	2016-Current	Fit Kit	Z039.10522
Notes	Where not supplied use original fittings	dB Killer	Z038.10565 (TYPE WW)

Estimated Fitting Time: 60 Minutes

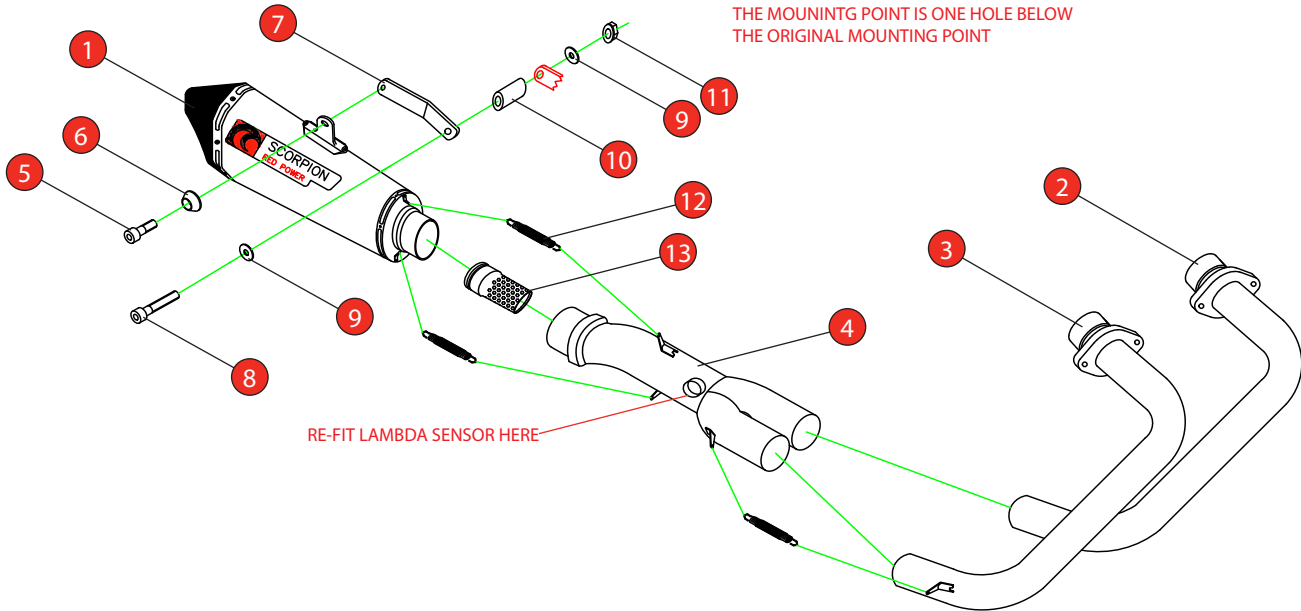

NO.	PART NO.	DESCRIPTION	QTY
1	RSC303	Serket Taper Silencer	1
2	CP788	L/H Header Pipe	1
3	CP789	R/H Header Pipe	1
4	CP790	Collector Pipe	1
Fit Kit - Z039.10522			
5	Z017.10073	M8 x 25mm Cap Head Bolt	1
6	Z026.20068	Alloy Bolt Finisher	1
7	Z015.31048	Mounting Bracket	1
8	Z017.10079	M8 x 55mm Cap Head Bolt	1
9	Z017.10825	M8 x 25mm Washer	2
10	Z026.10009	M8 x 35mm Alloy Spacer	1
11	Z017.10062	M8 Nyloc Nut	1
12	Z028.10030	Rubber Coated Spring	3
13	Z028.20188	Single Ended Flute	1

E-MARK	BSAU 193a 1990/t3
DATE	19/06/17
ISSUE	00
AUTHORISED	M.Ydlibi

NOTE: ENGINE SOLUTION SYSTEM IS CLEAR OF MOVING PARTS AND ALL ORIGINAL FUNCTIONS WORK CORRECTLY.

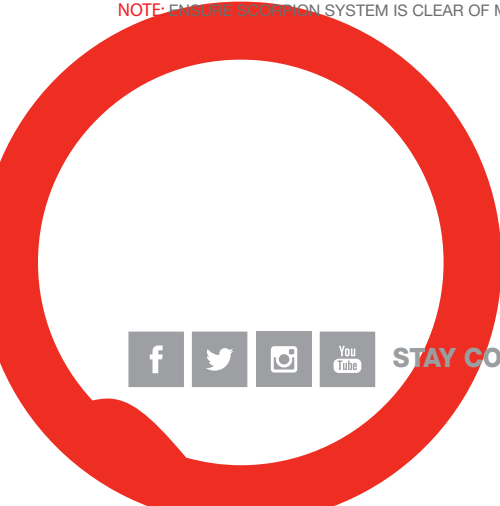

STAY CONNECTED TO RED POWER.

Bike	Tracer 700	Part No.	RYA-108-SYS
Year	2016-Current	Fit Kit	Z039.10522
Notes	Where not supplied use original fittings	dB Killer	Z038.10565 (TYPE WW)

Estimated Fitting Time: 60 Minutes



A) Remove original exhaust from bike, taking care to keep all original components in a safe place.

B) Refit Scorpion exhaust as per line diagram above.

C) When fitted take bike for a short ride to ensure all functions are correct.

D) When bike & exhaust are cool enough check all nuts and bolts are still secure.

Thank you for purchasing your Scorpion Silencer.

Care of your exhaust: Please refrain from cleaning silencer with heavy solvents or abrasives!

Vielen Dank Für den kauf eines Scorpion Schalldampfers! Pflegehinweis: Bitte verwenden Sie niemals Scheuermittel oder aggressive Reiniger zur Pflege Ihres Auspuffes!

Merci d'avoir choisi un echappement Scorpion.

Entretien de votre silencieux: Ne pas utiliser de solvants ou de produits abrasifs!

Muchas gracias por adquirir un Silencioso Scorpion. Le recomendamos no limpiar el silencioso con productos abrasivos o aquellos que contengan disolventes.



STAY CONNECTED TO RED POWER.