

Bike	Suzuki GSX-S 750	Part No.	SI-1010
Year	2017-Current	Fit Kit	Z039.10604
Notes	Where not supplied use original fittings	dB Killer	Z038.10552 (TYPE PP)

Estimated Fitting Time: 60 Minutes

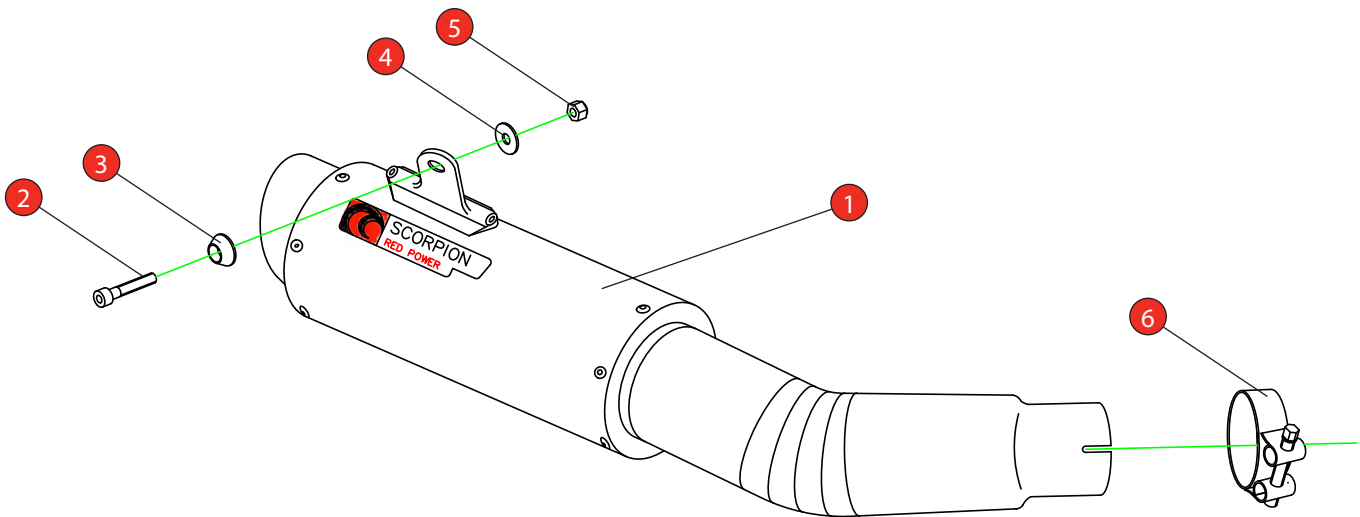

NO.	PART NO.	DESCRIPTION	QTY
1	SC402	RP1-GP Silencer With Intergrated Connecting Pipe	1
Fit Kit - Z039.10604			
2	Z017.10077	M8 x 45mm Cap Head Bolt	1
3	Z026.20068	Alloy Bolt Finisher	1
4	Z017.10825	M8 x 25mm Washer	1
5	Z017.10062	M8 Nyloc Nut	1
6	Z016.10008	43-47mm Clamp	1

E-MARK	e11 00519
DATE	26/04/17
ISSUE	00
AUTHORISED	M.Ydlibi

NOTE: ENSURE SCORPION SYSTEM IS CLEAR OF MOVING PARTS AND ALL ORIGINAL FUNCTIONS WORK CORRECTLY.

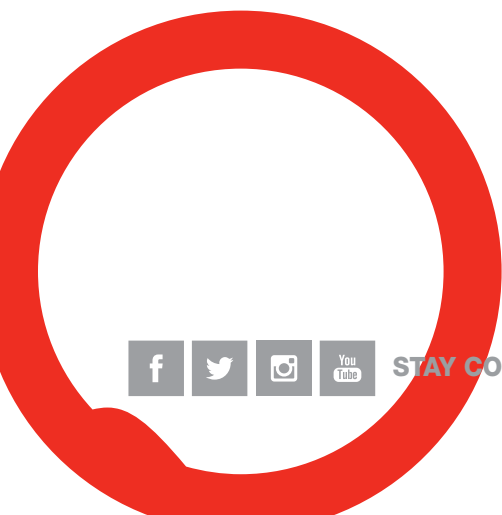

STAY CONNECTED TO RED POWER.

Bike	Suzuki GSX-S 750	Part No.	SI-1010
Year	2017-Current	Fit Kit	Z039.10604
Notes	Where not supplied use original fittings	dB Killer	Z038.10552 (TYPE PP)

Estimated Fitting Time: 60 Minutes



A) Remove original exhaust from bike, taking care to keep all original components in a safe place.

B) Refit Scorpion exhaust as per line diagram above.

C) When fitted take bike for a short ride to ensure all functions are correct.

D) When bike & exhaust are cool enough check all nuts and bolts are still secure.

Thank you for purchasing your Scorpion Silencer.

Care of your exhaust: Please refrain from cleaning silencer with heavy solvents or abrasives!

Vielen Dank Für den kauf eines Scorpion Schalldampfers! Pflegehinweis: Bitte verwenden Sie niemals Scheuermittel oder aggressive Reiniger zur Pflege Ihres Auspuffes!

Merci d'avoir choisi un echappement Scorpion.

Entretien de votre silencieux: Ne pas utiliser de solvants ou de produits abrasifs!

Muchas gracias por adquirir un Silencioso Scorpion. Le recomendamos no limpiar el silencioso con productos abrasivos o aquellos que contengan disolventes.



STAY CONNECTED TO RED POWER.