

Box: PLOCK 1

BIKE	HONDA CB 1300	PART NO.	EHA - 81
YEAR	2003 - 2014	FIT KITS	OVAL Z039.11055 // ROUND Z039.10055
NOTES	Use standard fittings where not supplied Remove standard gasket if fitted.	DB-Killer	SCEXDBK12 - (Type B)

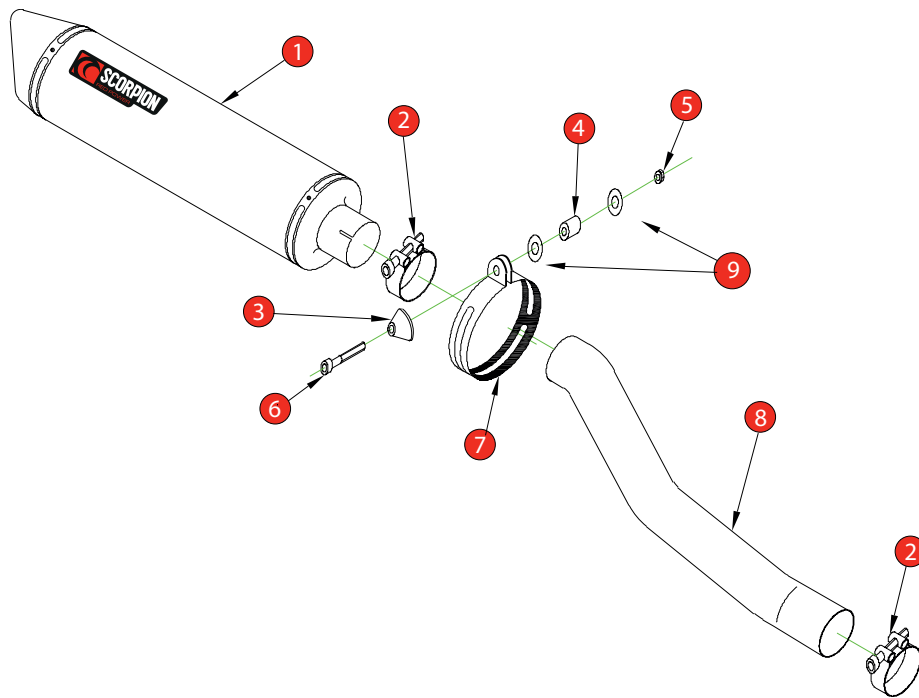

- | | |
|---|--------------------------------------|
| 1 450mm Silencer ESC 50 | 8 Connecting Pipe CP 139 |
| 2 2 x 51-55mm Band Clamp (Z016.10002) | 9 2 x M8 x 26mm Washers (Z017.10825) |
| 3 Aluminium Bolt Finisher (Z026.20068) | |
| 4 15mm Aluminium Spacer (Z026.10005) | |
| 5 M8 Nyloc Nut (Z017.10062) | |
| 6 M8 x 60mm Cap Head Bolt (Z017.10080) | |
| 7 Composite Silencer Strap (R-Z038.10090)(O-Z038.10088) | |

E-MARK ROUND	SCDB-RS [e4] 2035
E-MARK OVAL	SCDB-OS [e4] 2072
ISSUE NO.	07
DATE	09/10/2018
AUTHORISED	J.Harkin
CHECKED	

NOTE: ENSURE SCORPION SYSTEM IS CLEAR OF MOVING PARTS AND ALL ORIGINAL FUNCTIONS WORK CORRECTLY.



A) Remove original exhaust from bike, taking care to keep all original components in a safe place.

B) Refit Scorpion exhaust as per line diagram above.

C) When fitted take bike for a short ride to ensure all functions are correct.

D) When bike & exhaust are cool enough check all nuts and bolts are still secure.