

Box: PLOCK 2x2

BIKE	HONDA VTR 1000 FIRESTORM	PART NO.	EHA - 55
YEAR	1997 - 2004	FIT KITS	OVAL Z039.11047 // ROUND Z039.10047
NOTES	Use standard fittings where not supplied Remove standard gasket if fitted.	DB-Killer	SCEXDBK12 - (Type B)

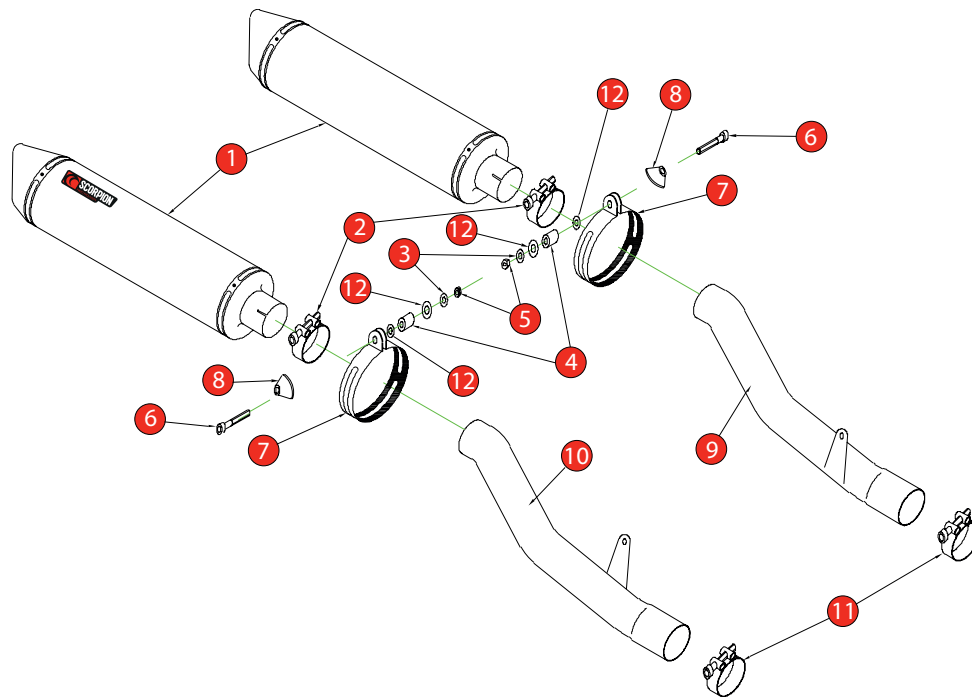

1 2 x 450mm Silencers ESC 50	8 2 x Aluminium Bolt Finishers (Z026.20068)
2 2 x 51-55mm Band Clamps (Z016.10002)	9 Connecting Pipe CP7
3 4 x M8 x 17mm Washers (Z017.10831)	10 Connecting Pipe CP8
4 2 x 10mm Aluminium Spacers (Z026.10004)	11 2 x 43-47mm Band Clamps (Z016.10008)
5 2 x M8 Lock Nuts (Z017.10062)	12 4 x 8 x 25mm Washers (Z017.10825)
6 2 x M8 x 60mm Cap Head Bolts (Z017.10080)	13 2 x Bump Stop Kits (Z017.10010)
7 2 x Comp Silencer Straps (R-Z038.10090) (O-Z038.10088)	

E-MARK ROUND	SCDB-RS e4 2035
E-MARK OVAL	SCDB-OS e4 2072
ISSUE NO.	08
DATE	17/10/2018
AUTHORISED	J.Harkin
CHECKED	

NOTE: ENSURE SCORPION SYSTEM IS CLEAR OF MOVING PARTS AND ALL ORIGINAL FUNCTIONS WORK CORRECTLY.

A) Remove original exhaust from bike, taking care to keep all original components in a safe place.

B) Refit Scorpion exhaust as per line diagram above.

C) When fitted take bike for a short ride to ensure all functions are correct.

D) When bike & exhaust are cool enough check all nuts and bolts are still secure.