

Bike	Suzuki GSX 1300	Part No.	RSI-112
Year	2008-2017	Fit Kit	Z039.10467
Notes	Where not supplied use original fittings	dB Killer	SCEXDBK23 X 2 (TYPE V)

Estimated Fitting Time: 60 Minutes

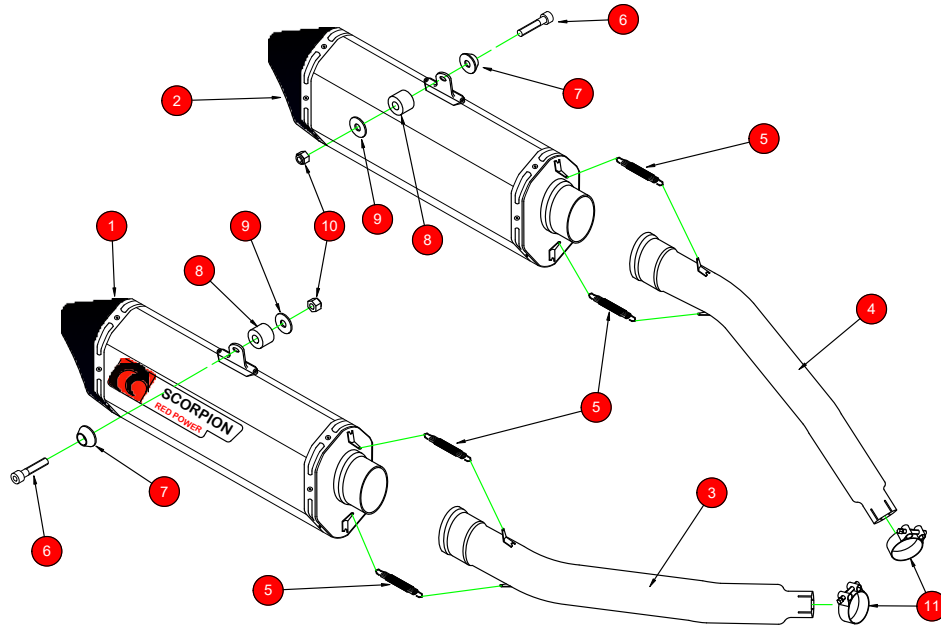

NO.	PART NO.	DESCRIPTION	QTY
1	RSC248	R/H Serket Silencer	1
2	RSC249	L/H Serket Silencer	1
3	CP700	R/H Connecting pipe	1
4	CP699	L/H Connecting Pipe	1
Fit Kit - Z039.10467			
5	Z028.10030	Rubber Coated Springs	4
6	Z017.10080	M8 x 60mm Cap Head Bolt	2
7	Z026.20068	Alloy Bolt Finisher	2
8	Z26.10005	15mm Alloy Spacer	2
9	Z017.10825	M8 x 25mm Washer	2
10	Z017.10062	M8 Nyloc Nuts	2
11	Z016.10008	43-47mm Clamp	2

E-MARK	BSAU 193a 1990/t3
DATE	26/07/21
ISSUE	03
AUTHORISED	M.Ydlibi

NOTE: ENSURE SCORPION SYSTEM IS CLEAR OF MOVING PARTS AND ALL ORIGINAL FUNCTIONS WORK CORRECTLY.

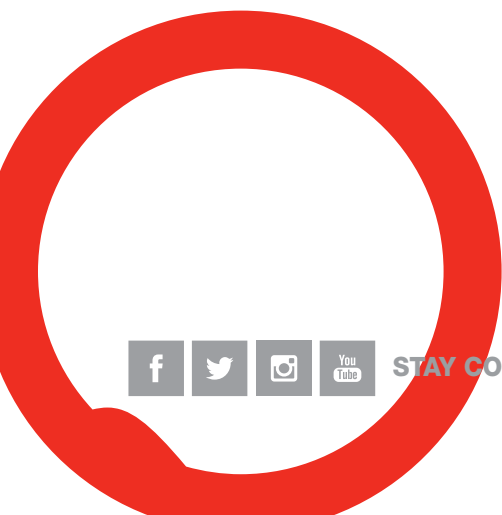

STAY CONNECTED TO RED POWER.

Bike	Suzuki GSX 1300	Part No.	RSI-112
Year	2008-2017	Fit Kit	Z039.10467
Notes	Where not supplied use original fittings	dB Killer	SCEXDBK23 X 2 (TYPE V)

Estimated Fitting Time: 60 Minutes



A) Remove original exhaust from bike, taking care to keep all original components in a safe place.

B) Refit Scorpion exhaust as per line diagram above.

C) When fitted take bike for a short ride to ensure all functions are correct.

D) When bike & exhaust are cool enough check all nuts and bolts are still secure.

Thank you for purchasing your Scorpion Silencer.

Care of your exhaust: Please refrain from cleaning silencer with heavy solvents or abrasives!

Vielen Dank Für den kauf eines Scorpion Schalldampfers! Pflegehinweis: Bitte verwenden Sie niemals Scheuermittel oder aggressive Reiniger zur Pflege Ihres Auspuffes!

Merci d'avoir choisi un echappement Scorpion.

Entretien de votre silencieux: Ne pas utiliser de solvants ou de produits abrasifs!

“Muchas gracias por adquirir un Silencioso Scorpion. Le recomendamos no limpiar el silencioso con productos abrasivos o aquellos que contengan disolventes.”



STAY CONNECTED TO RED POWER.